

EL10 L1.05M 2KSG 10 (410 910)

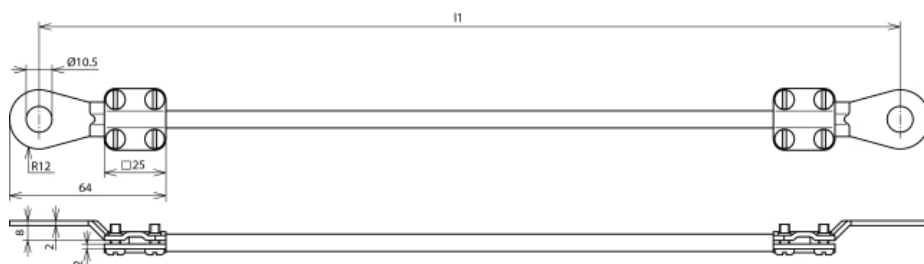

Figure without obligation

Type	EL10 L1.05M 2KSG 10
Part No.	410 910
Cable cross section	10 mm ²
Cable length (l1)	1.05 m
Cable lug closed	2x M10
Hole Ø	10.5 mm
Conductor	Cu highlyflexible
Operating voltage resistance (AC / DC)	600 V
Temperature range	-40 °C ... +150 °C
Colour	black •
Cable lug material	Cu/gal Sn
Screw	⬆ M4 x 10 mm
Material of screw	St/gal Zn
Weight	200 g
Customs tariff number (Comb. Nomenclature EU)	85389099
Stock No.	6150-12-198-1482
GTIN	4013364029064
PU	1 pc(s)

We reserve the right to introduce changes in performance, configuration and technology, dimensions, weights and materials in the course of technical progress. The figures are shown without obligation.

Packing in accordance with specifications of the VG standards (defence equipment standards) must be explicitly indicated when ordering.